

6 ASSEMBLY OF THE RIGHT LEGS

INSERT ⑧ & ⑬, ⑧ & ⑭
AS SHOWN.

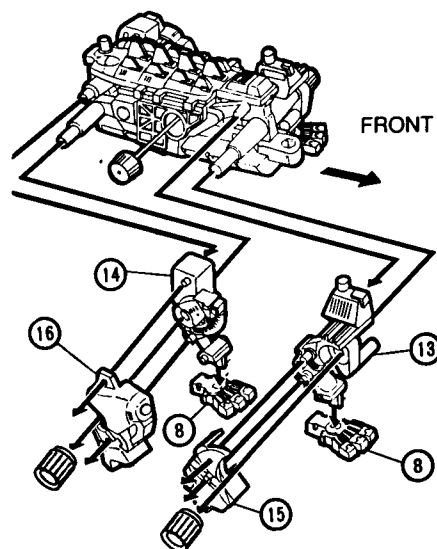

7 ASSEMBLY OF THE HEAD

SLIDE LOWER JAW INTO
UPPER JAW.

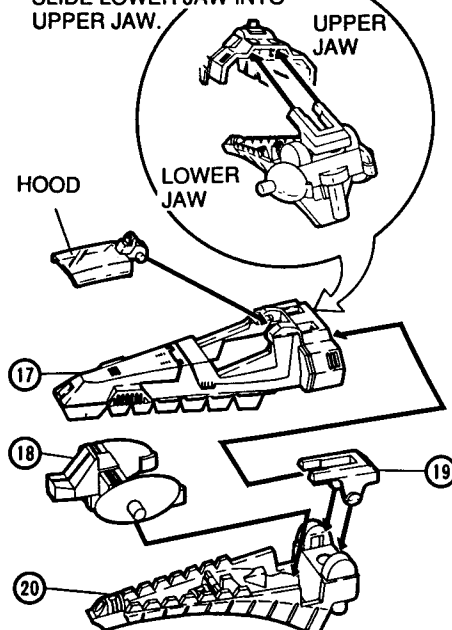

8 PILOT

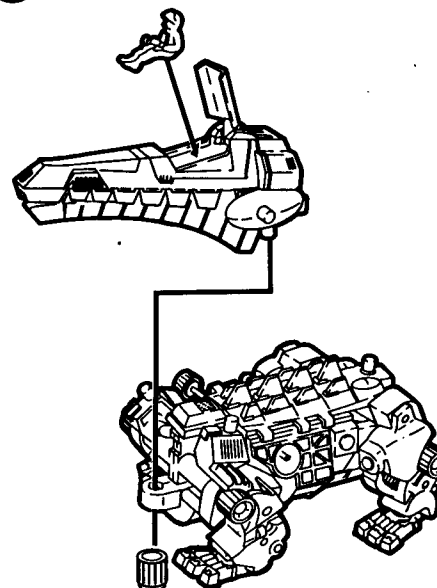

9 ASSEMBLY OF THE TAIL

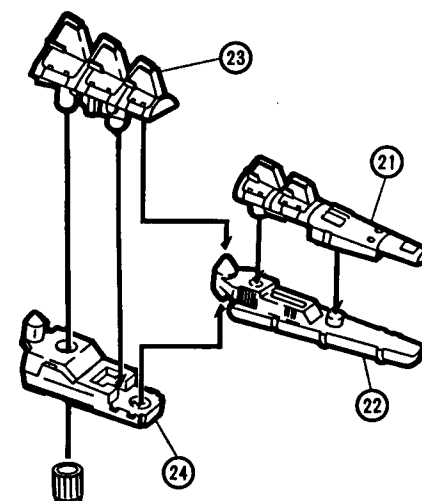

10 ASSEMBLY OF THE TAIL

ASSEMBLE ②⑤ & ②⑥ TO THE REAR.
HOLD PARTS IN PLACE AS YOU
INSERT TAIL AS SHOWN. ATTACH
CAP TO HOLD PARTS TOGETHER.

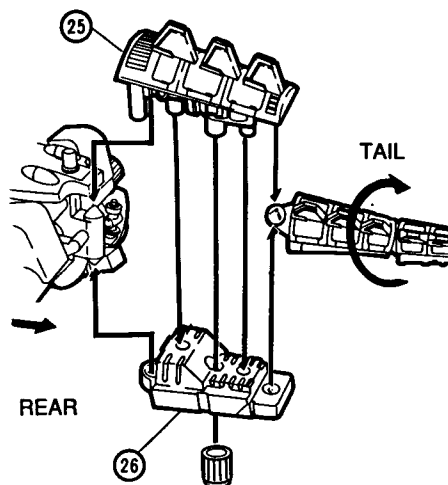

11 ASSEMBLE ②⑦ & ②⑧ SO THAT THEY DON'T TOUCH AT THE HEAD.

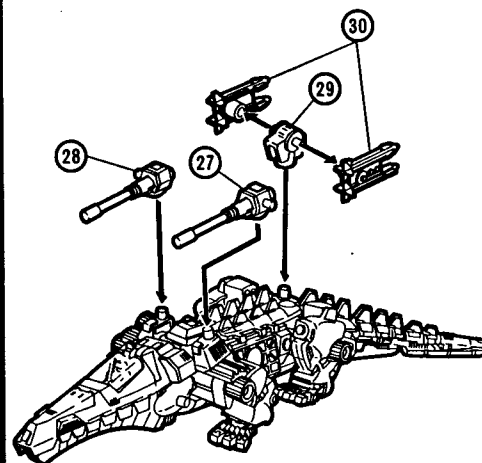

TO OPERATE: WIND UP THE MOTOR.
PLACE TOY ON A SMOOTH,
HARD, LEVEL SURFACE FOR
BEST MOVEMENT.

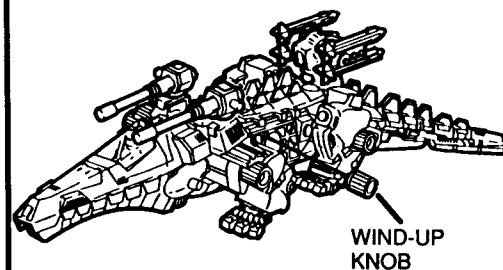

Kenner

©1994 Kenner, a Division
of Tonka Corporation,
Cincinnati, Ohio 45202

51473800

TECHNO ZIDS™

ARMORED GATOR™

6/8/94

IMPORTANT

Please read this **BEFORE** you begin.

1. Read and follow all instructions in order. Do not skip around when assembling this toy.
2. Lay out all parts as shown in Parts Panel before you begin to assemble your toy. This will enable you to identify the parts and familiarize yourself with the numbering system.
3. Before you remove any part, make sure you have checked that the number on the part matches the number in the instruction drawing.
4. To avoid breaking, carefully trim parts from the frame using a nail clipper, wire cutter or similar household tool. Remove any excess plastic from the part before snapping the parts together. You **do not** need glue to hold the parts together. Assemble the part before removing another part from the frame. You may have to hold some parts together in the process.
5. After following the step-by-step assembly, your toy will be ready for play.

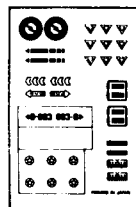

LABELS

CAPS

APPLY LABELS AS YOU LIKE.

PARTS PANEL



HOOD



PILOT

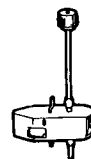

WIND-UP UNIT

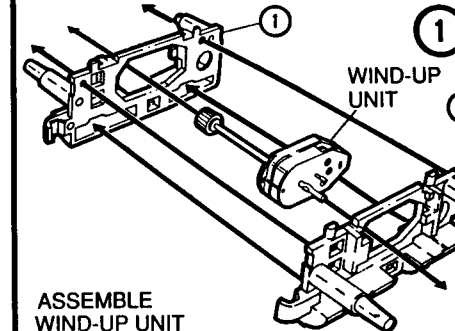
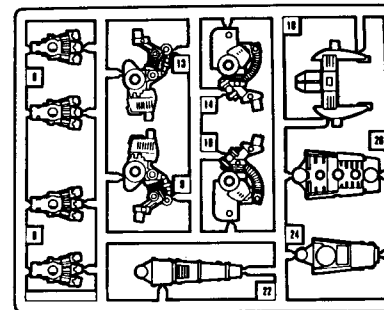
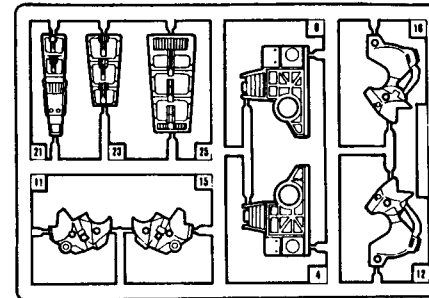
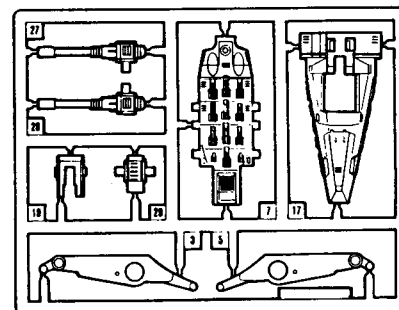
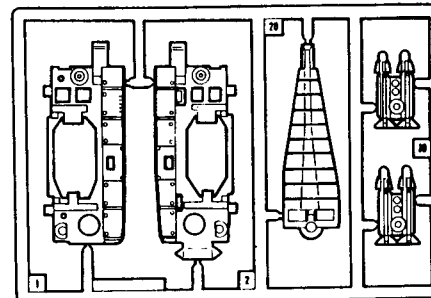

ASSEMBLE WIND-UP UNIT TO ② FIRST. THEN ASSEMBLE ① TO ② BRINGING THEM TOGETHER THEN SLIDING ① DOWN OVER HOOKS ON ② AS SHOWN BELOW.

FRONT VIEW

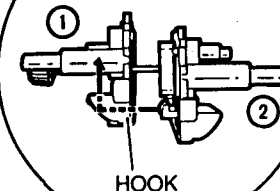

2

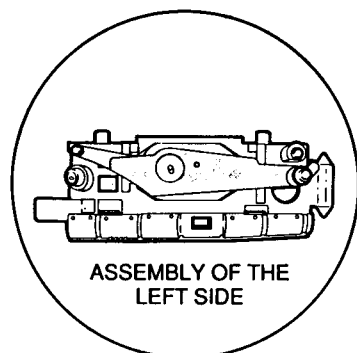

ASSEMBLY OF THE LEFT SIDE

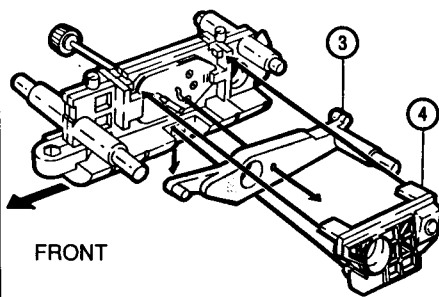

FRONT

3

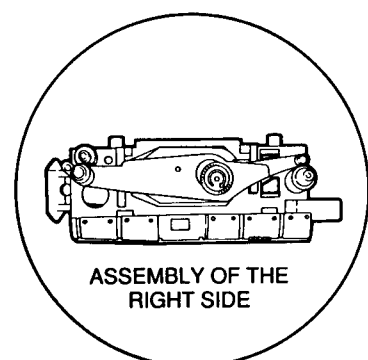

ASSEMBLY OF THE RIGHT SIDE

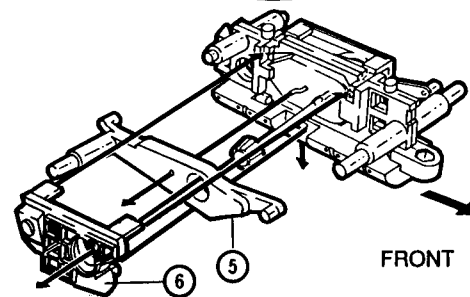

FRONT

4

PART ⑦ WILL SNAP OVER PARTS ④ & ⑥ TO HOLD ASSEMBLY TOGETHER

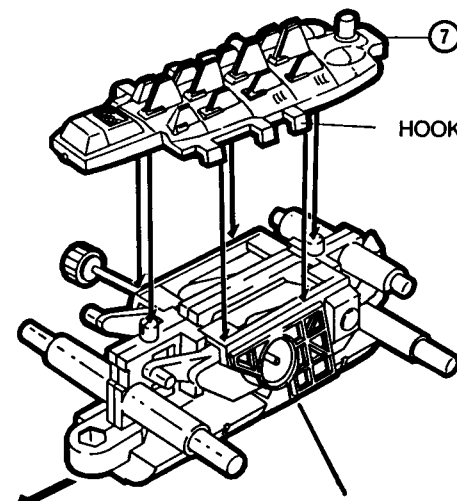

HOOK

FRONT

HOLD ASSEMBLY TOGETHER UNTIL YOU SNAP PART ⑦ IN PLACE.

5

ASSEMBLY OF THE LEFT LEGS

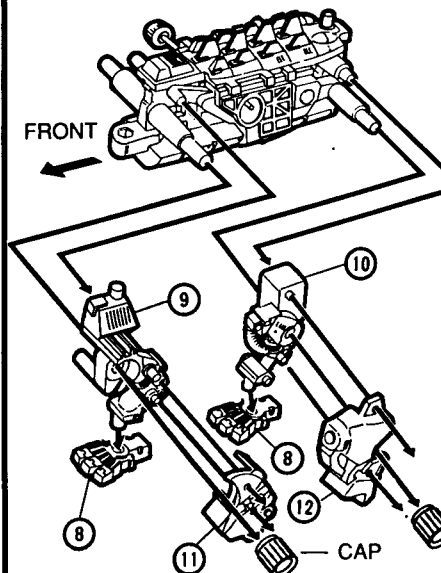

CAP

INSERT ⑧ & ⑨, ⑧ & ⑩ AS SHOWN